

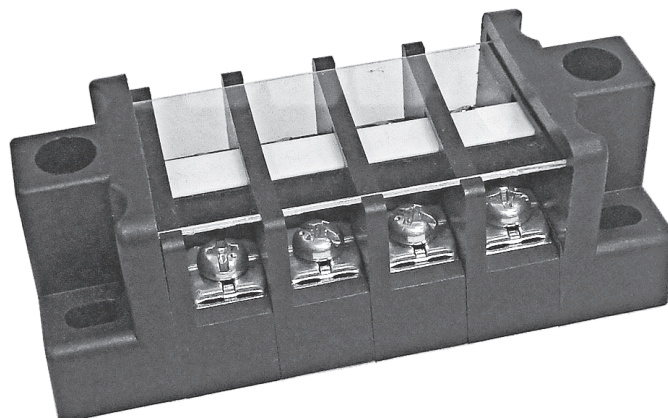

TYPE: TFDM (貫通式端子台)

Pitch:12.70mm



ORDER GUIDE(注文方法):

TFDM-04

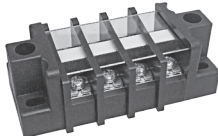
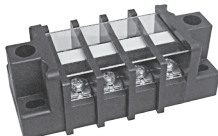
| Body(本体) | Terminal style(端子スタイル) | Poles(極数) |
|---|--|-----------|
| <p>TFD本體 (with mounts)</p>  | M   | 02 |
| <p>TFD-A本體 (wide housing with mounts)</p>  | | 16 |

SPECIFICATION(規格,仕様):

| | | | |
|------------------------------|--------------------------|----------|--------------------|
| Terminal : | Brass, Ni plated, 1.0 t | 端子金具 : | 黄銅板 ニッケルメッキ, 1.0 t |
| Insulator body : | PBT(UL94V-0), Black | 本体 : | PBT(UL94V-0), 黒色 |
| Screw : | M4.0, steel, Zinc plated | 端子ネジ : | M4.0, 鉄 亜鉛メッキ |
| Operation temperatures : | -40° C to +120° C | 使用温度範囲 : | -40° C to +120° C |
| Rated current : | 30Amp 600V | 定格 : | 30Amp 600V |
| Insulation withstands volt : | 2000V 1min | 耐電圧 : | 2000V 一分間 |
| Insulation resistance : | 2000MΩ at DC 500V | 絶縁抵抗 : | DC 500V 2000MΩ |
| Wire range : | 10~20 AWG | 適合電線 : | 10~20 AWG |
| Screw torque : | 18 lb-in | 締付トルク : | 18 lb-in |
| | Screw with washer | | ワッシャー付ネジ |

.500" PCB Barrier Terminal Blocks

TYPE: TFDM

Pitch:12.70mm

TFDM-04

Terminal style:M

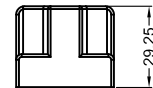
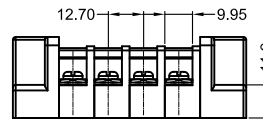
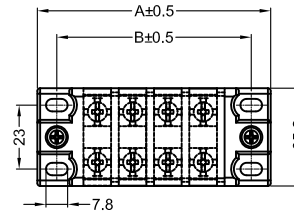
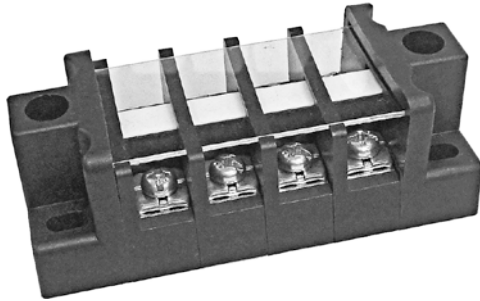

TFDM-A04

Terminal style:M

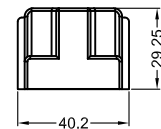
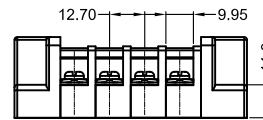
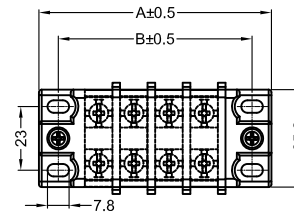
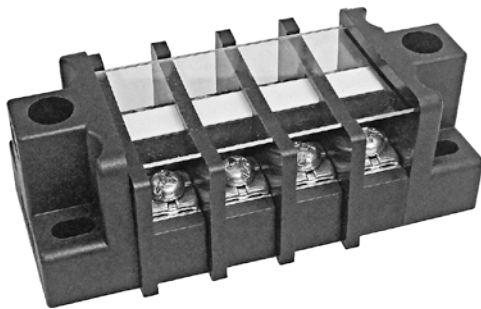

| Poles | 2 | 3 | 4 | 5 | 6 | 7 | 8 | 9 | 10 | 11 | 12 | 13 | 14 | 15 | 16 |
|-------|-------|-------|-------|-------|--------|--------|--------|--------|--------|--------|--------|--------|--------|--------|--------|
| A(mm) | 58.60 | 71.30 | 84.00 | 96.70 | 109.40 | 122.10 | 134.80 | 147.50 | 160.20 | 172.90 | 185.60 | 198.30 | 211.00 | 223.70 | 236.40 |
| B(mm) | 44.60 | 57.30 | 70.00 | 82.70 | 95.40 | 108.10 | 120.80 | 133.50 | 146.20 | 158.90 | 171.60 | 184.30 | 197.00 | 209.70 | 222.40 |